

to thermal or moisture expansion of the restrained masonry panel in some situations.

ACTIONS - Concrete and masonry elements

The designer should:

- carefully consider the construction programme if relying on elements external to the steel frame for bracing
- provide a means of adjustment which can accommodate the different tolerance requirements for the different materials
- design and detail connections between the different materials which can reasonably be made on site
- manage the interface.

6.3 Timber elements

Timber may be used for the secondary elements in a building frame, such as rafters, purlins, ceiling joists and floor joists. Suggested connection details at interfaces between these elements and the steel frame are illustrated in Figure 6.6. These details are simple and self explanatory.

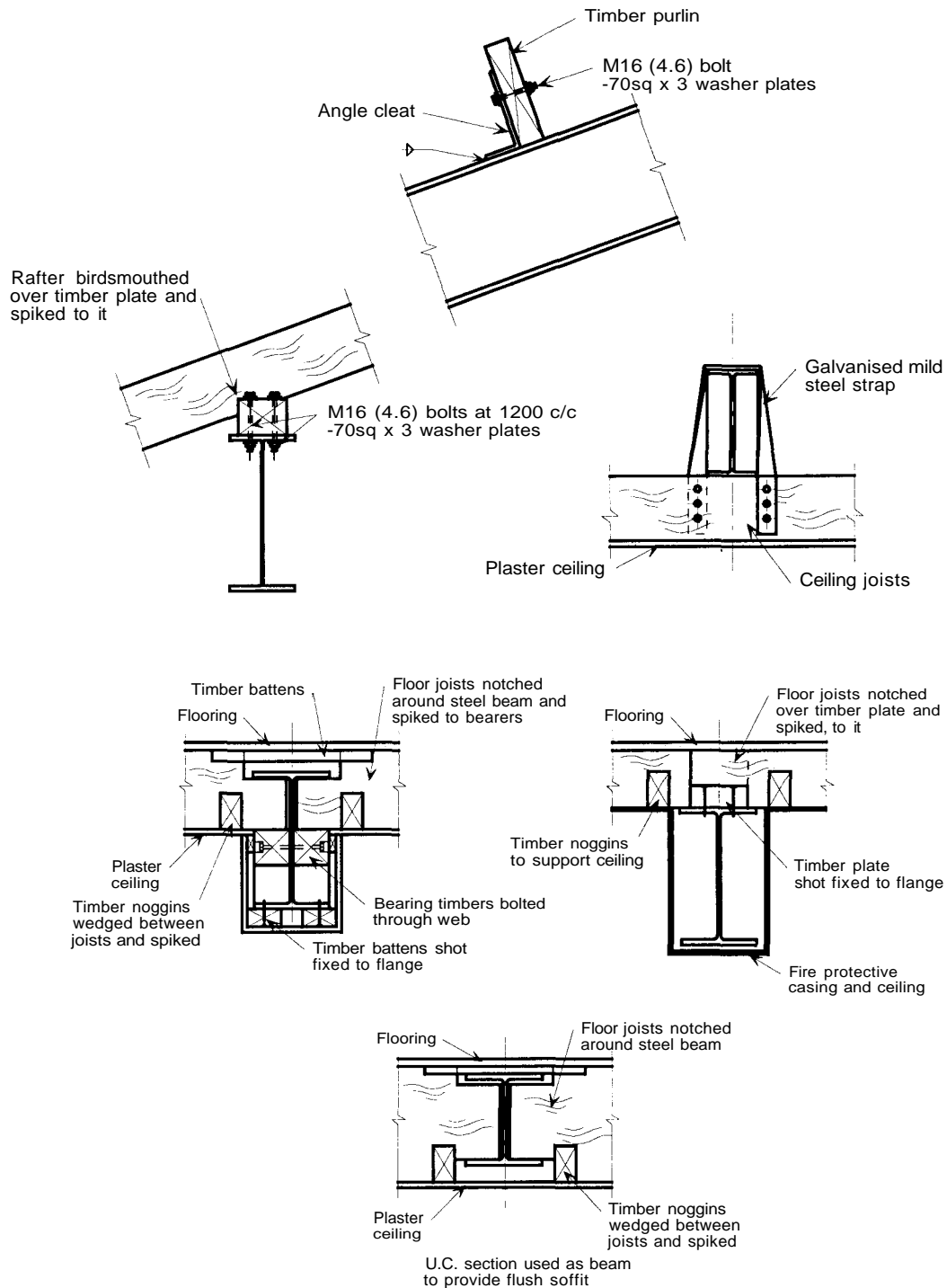

Figure 6.6 Attachments between timber and steel elements